

Drawing 12.

S Panel Wall PIR; MWF; EPS - horizontal configuration, ground beam joint

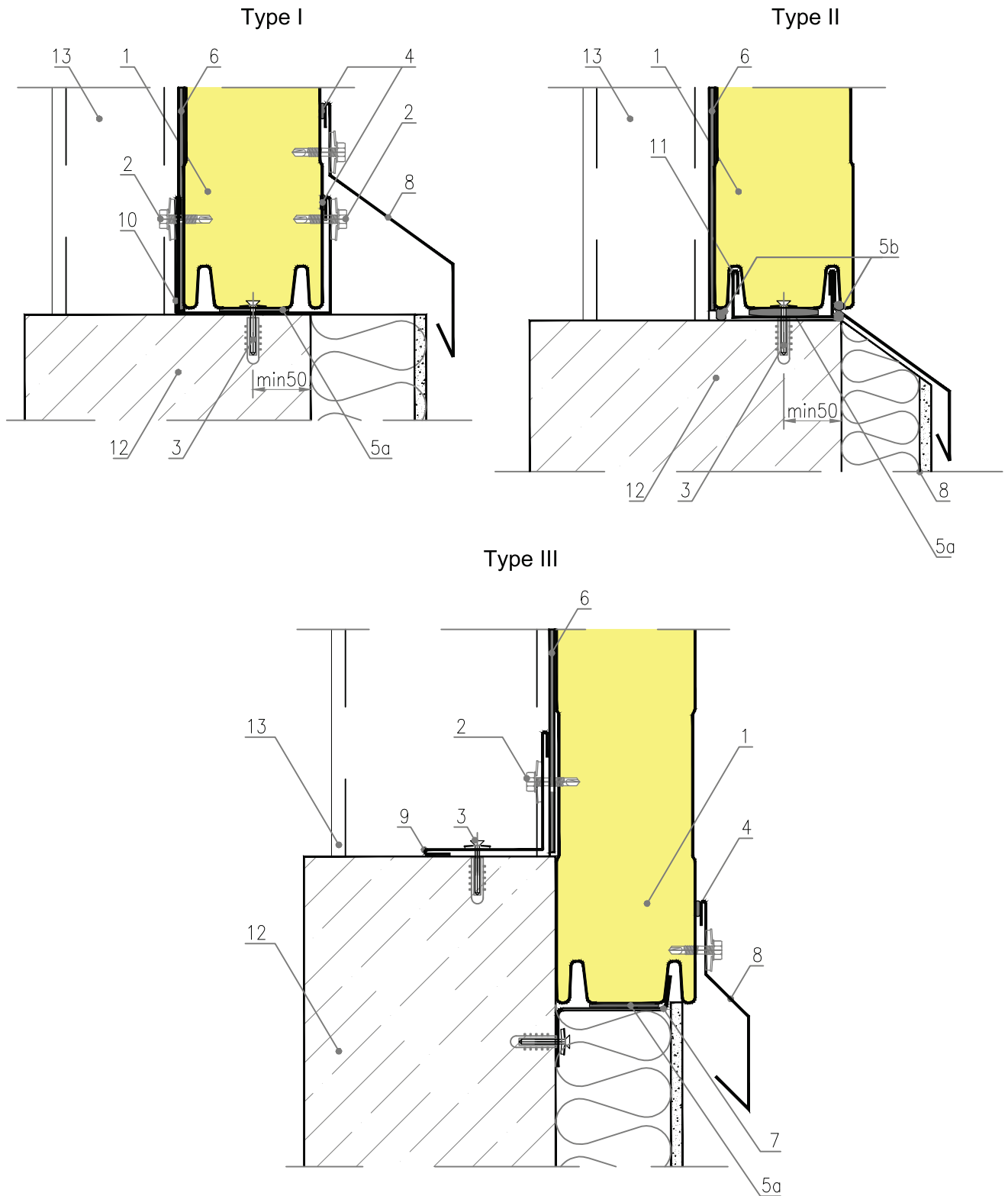

- 1. S Panel Wall panel
- 2. Drive screw with EPDM washer
- 3. Nail plug screw
- 4. Sealant, permanently plastic
- 5a. PURS tape / polyurethane foam
- 5b. PURS tape
- 6. Self-adhesive PES sealing tape

- 7. Custom Ob-00 flashing (specify parameters and section drawing)
- 8. Ob-07 flashing
- 9. Ob-11 flashing
- 10. Ob-20 flashing
- 11. Ob-41 flashing
- 12. Ground beam
- 13. Steel section, according to the design of the structure