

Drawing 7.
S Panel Wall PIR; MWF; EPS - horizontal configuration, fastening to the structure

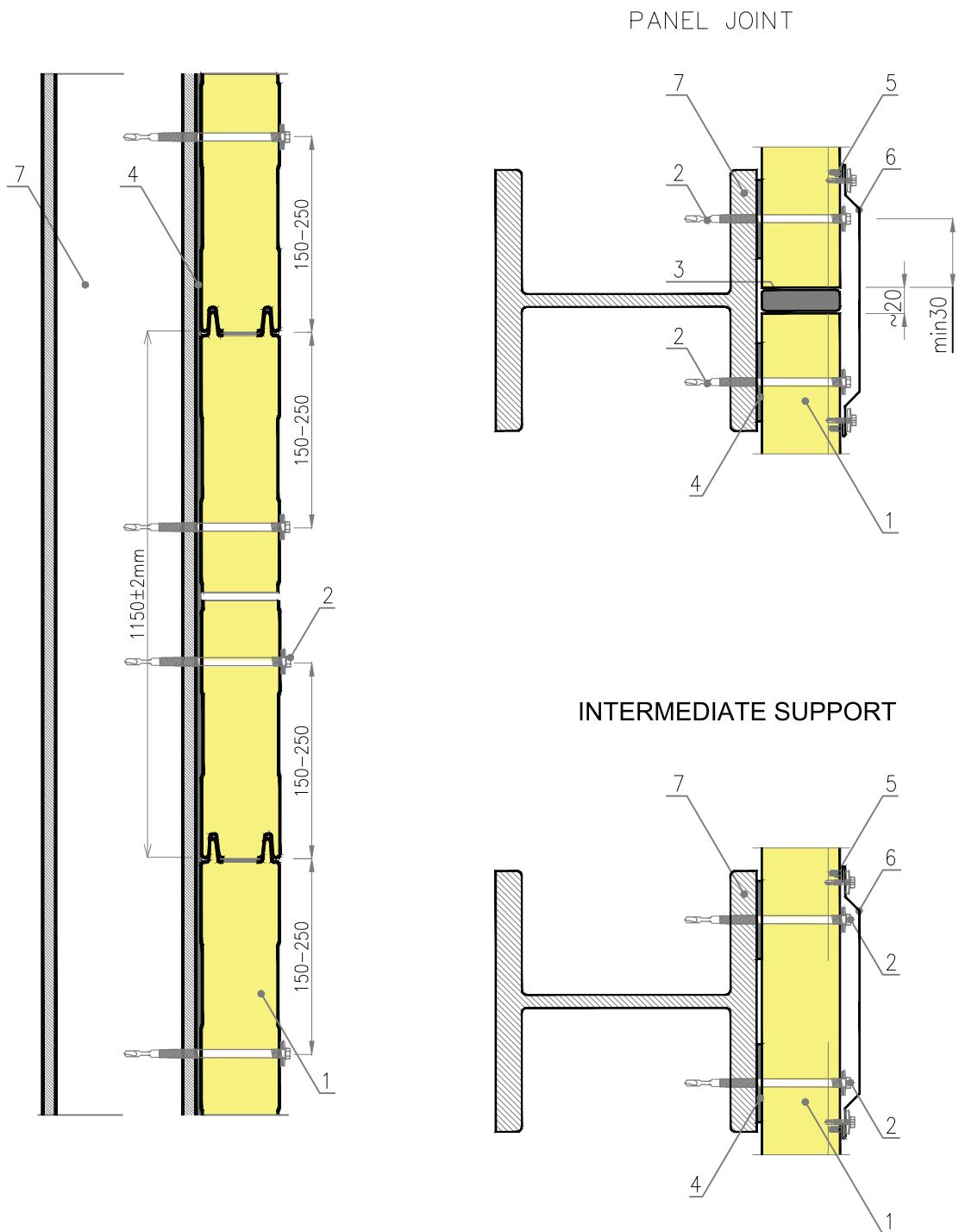

1. S Panel Wall panel
2. Drive screw with EPDM washer
3. Polyurethane foam as ~20 mm movement joint fill
4. Self-adhesive PES sealing tape
5. Sealant, permanently plastic
6. Ob-35 flashing
7. Steel section, according to the design of the structure